

hermod_89

ESCALA 1:1

- Ⓛ Sezione verticale traverso inferiore
- Ⓧ Section verticale traverse inferieure
- Ⓧ Seccion vertical travesañño inferior
- Ⓧ Vertical section lower ledger

1

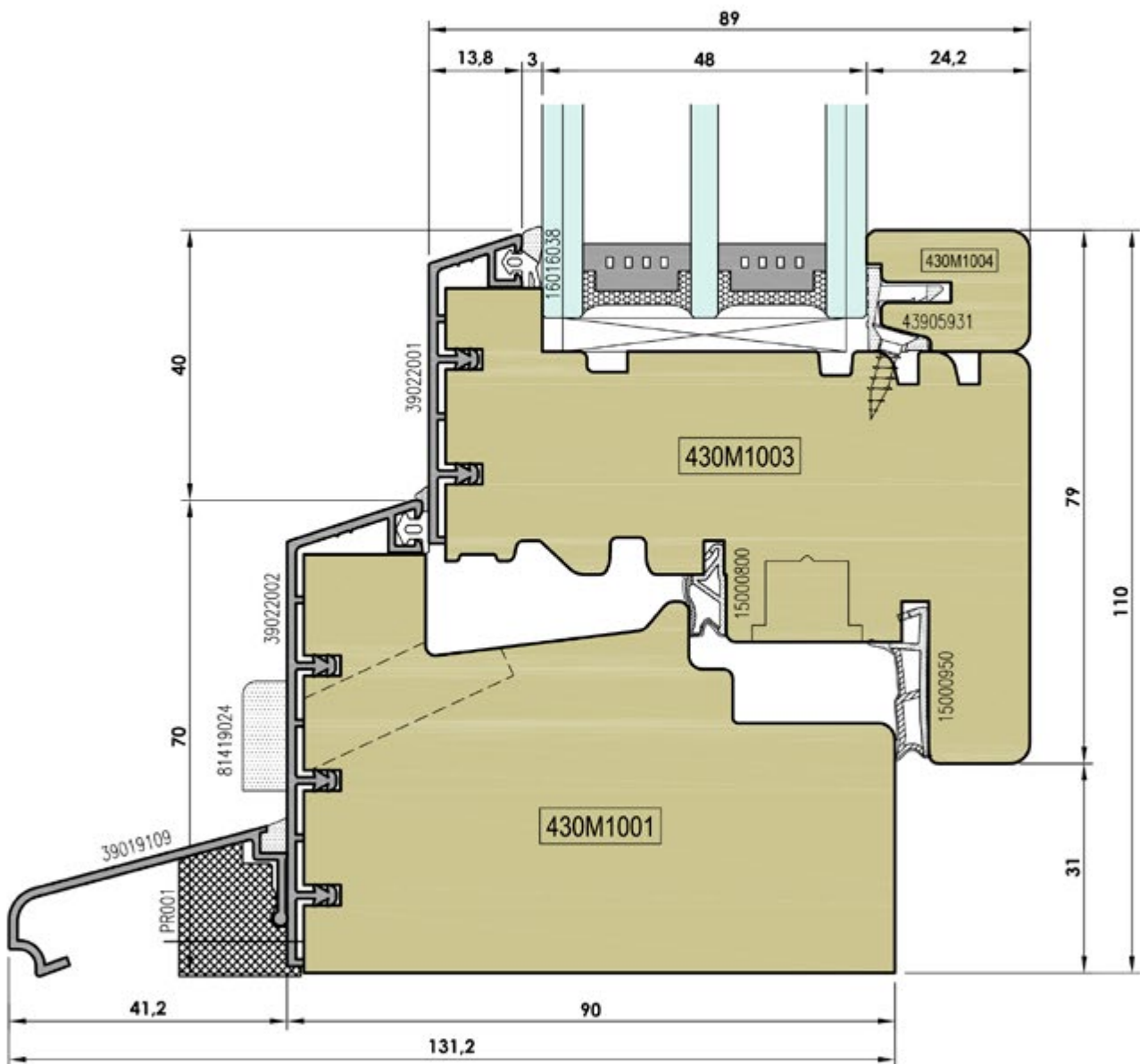
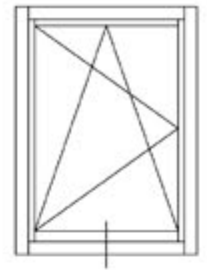

hermod_89

ESCALA 1:1

- (I) Sezione verticale traverso inferiore
- (F) Section verticale traverse inferieure
- (E) Seccion vertical travesañño inferior
- (UK) Vertical section lower ledger

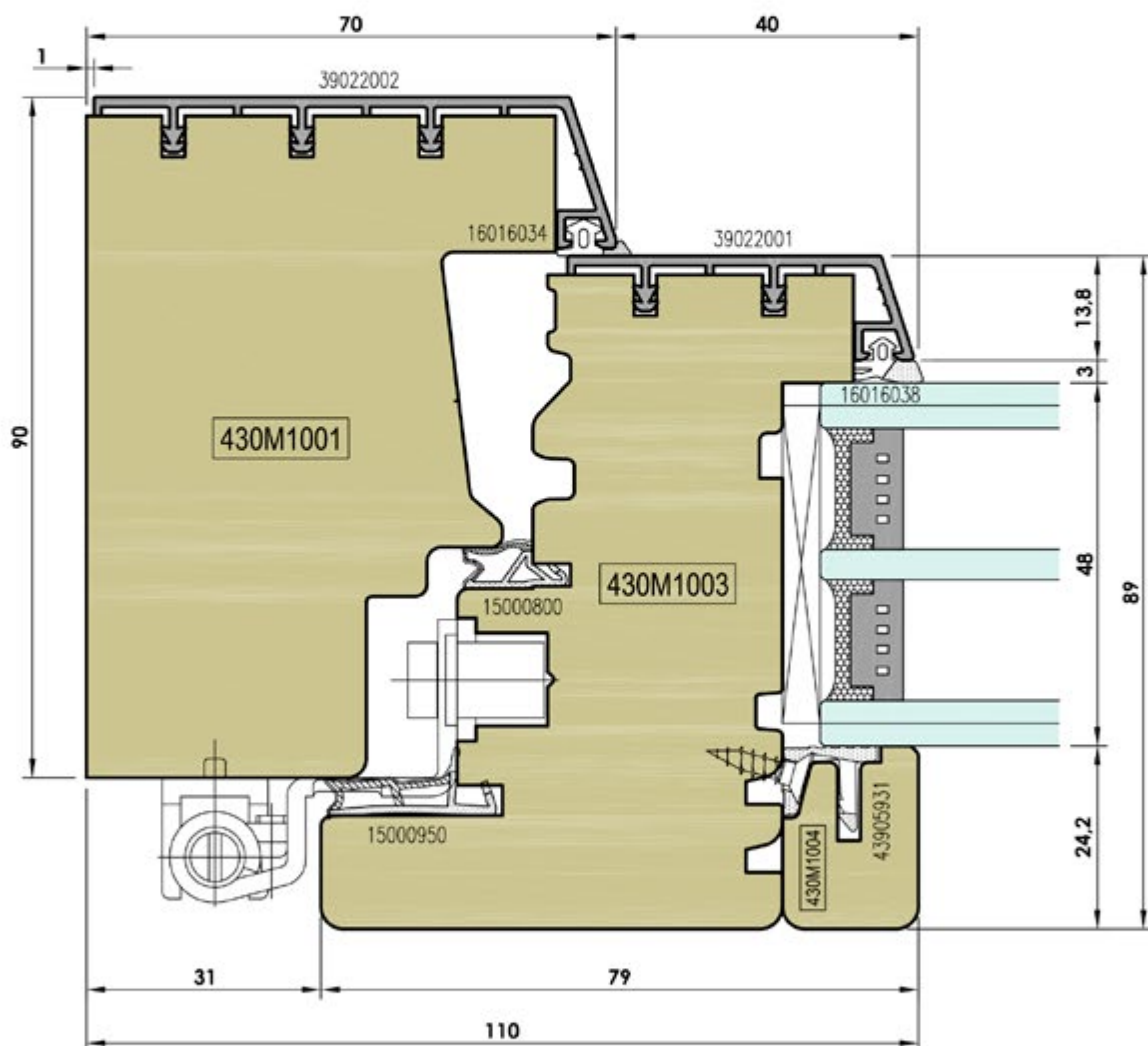
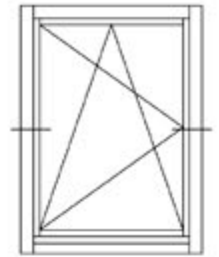

hermod_89

ESCALA 1:1

- Ⓛ Sezione orizzontale montante
- Ⓧ Section horizontale montant
- Ⓝ Seccion horizontal montante
- Ⓢ Horizontal section of the jamb

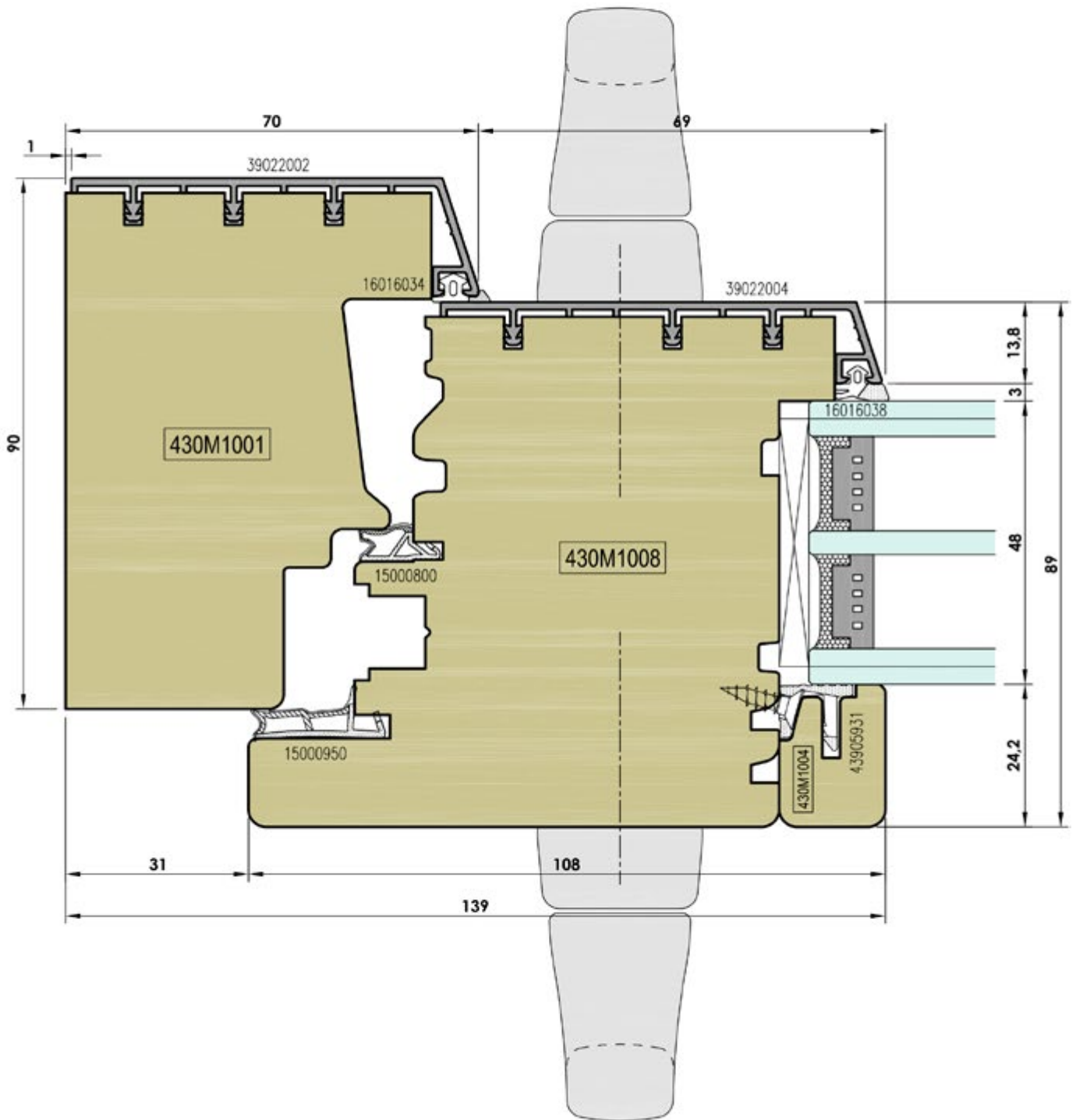
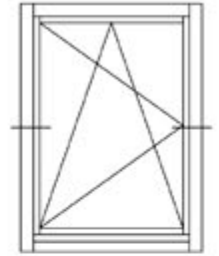

hermod_89

ESCALA 1:1

4

- (I) Sezione orizzontale montante
- (F) Section horizontale montant
- (E) Seccion horizontal montante
- (UK) Horizontal section of the jamb

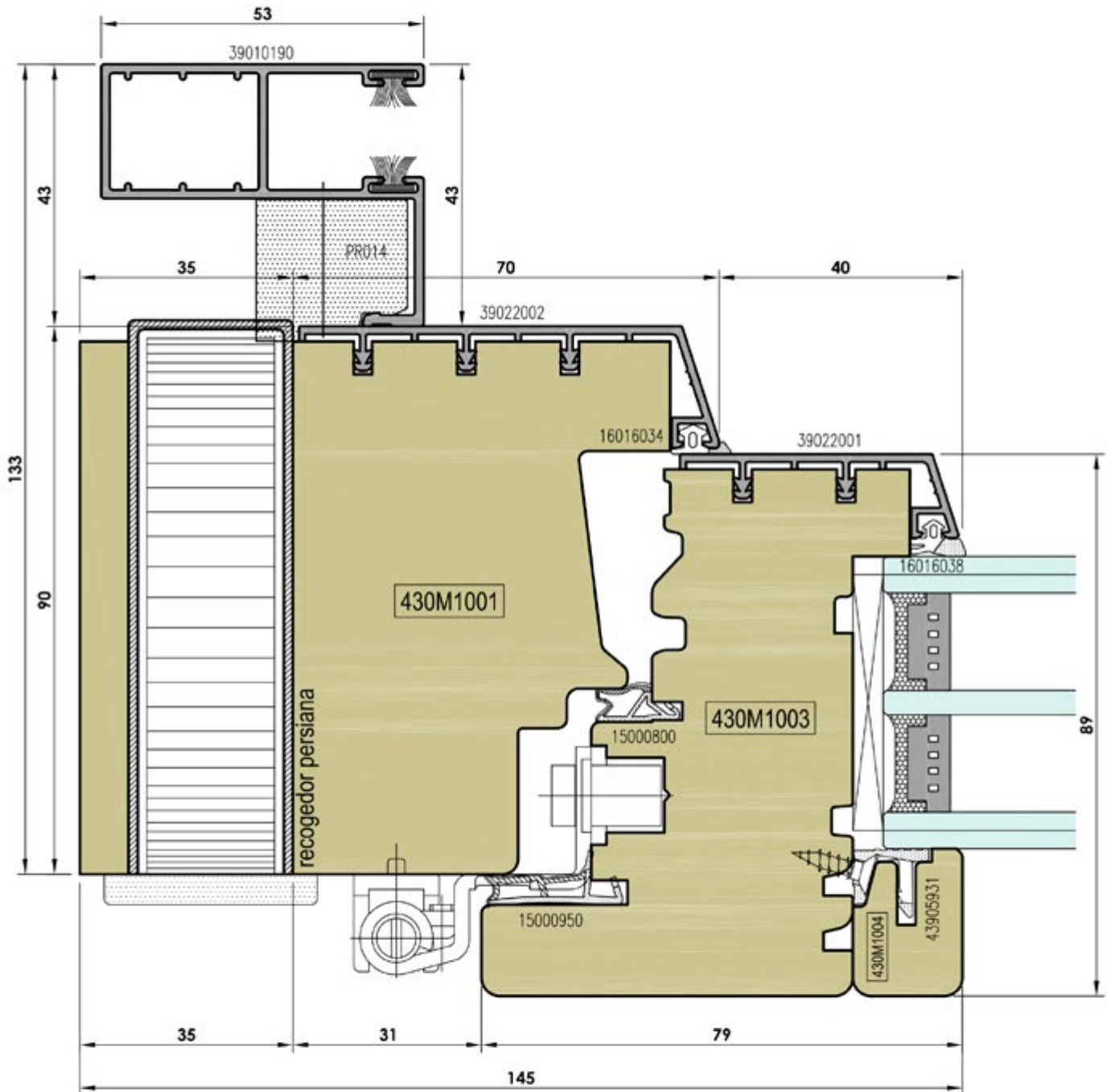
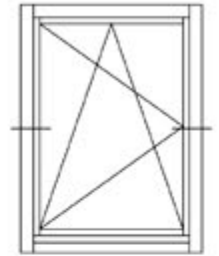

hermod_89

ESCALA 1:1

- (I) Sezione orizzontale montante
- (F) Section horizontale montant
- (E) Seccion horizontal montante
- (UK) Horizontal section of the jamb

5

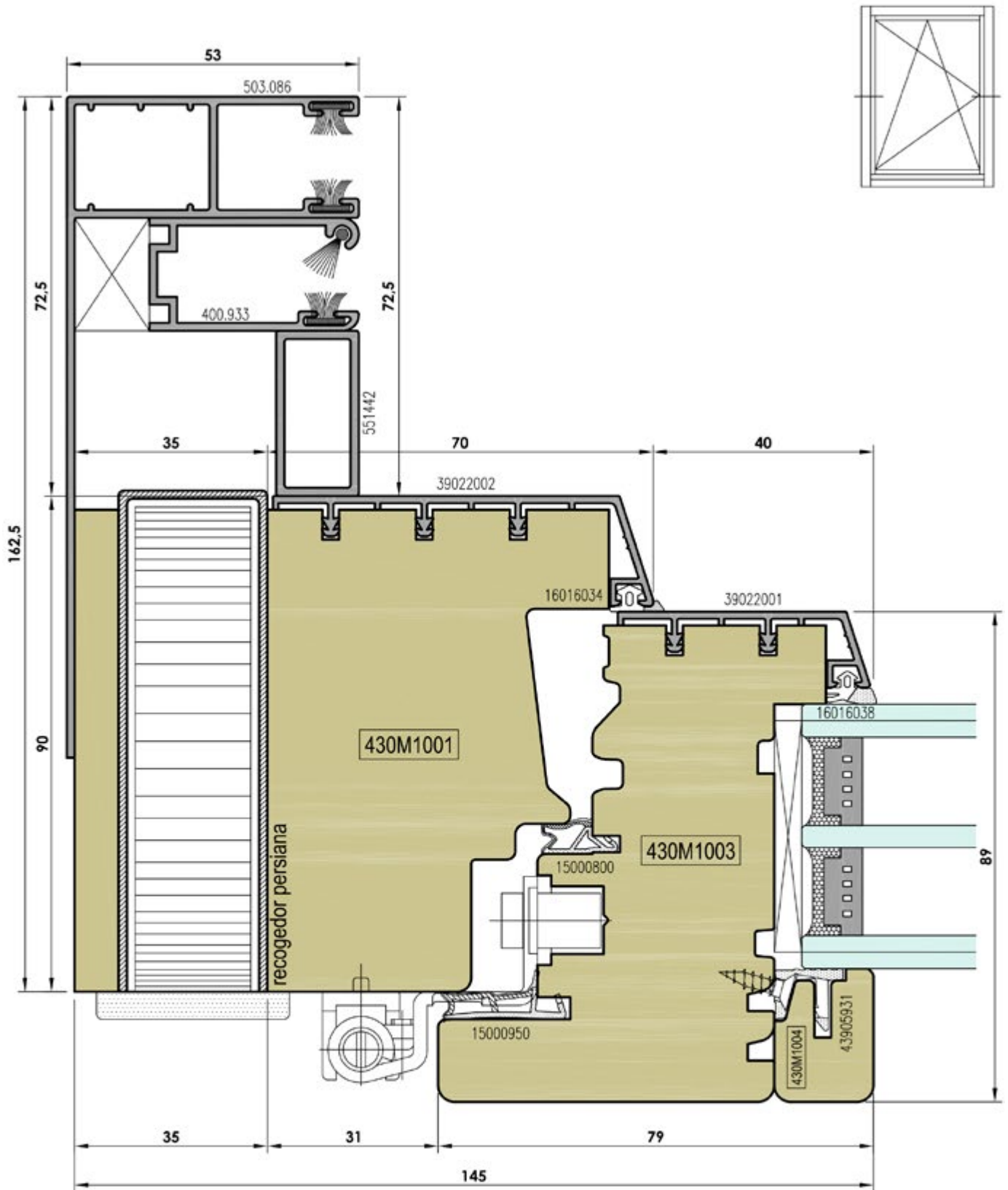

hermod_89

ESCALA 1:1

- (I) Sezione orizzontale montante
- (F) Section horizontale montant
- (E) Seccion horizontal montante
- (UK) Horizontal section of the jamb

6

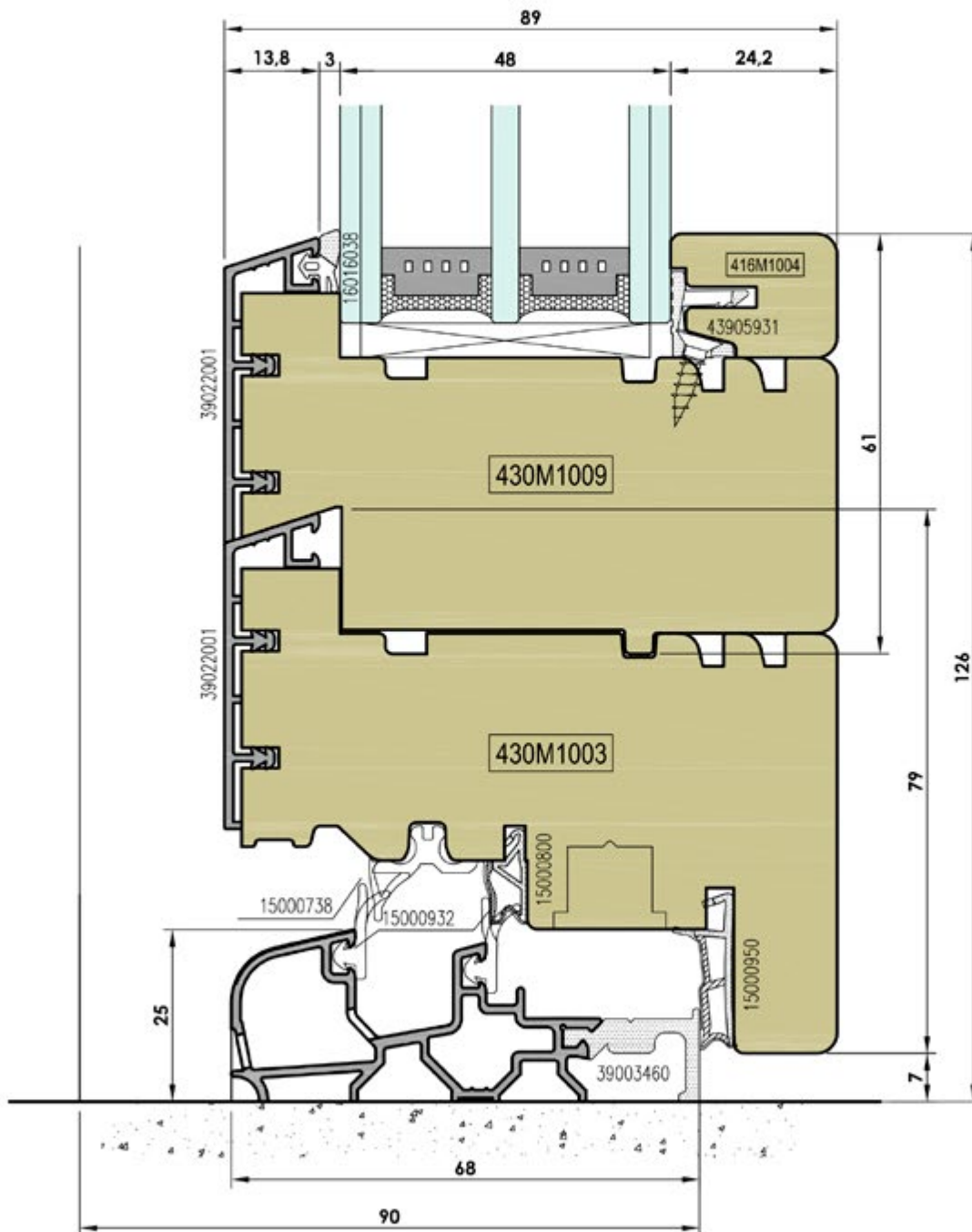
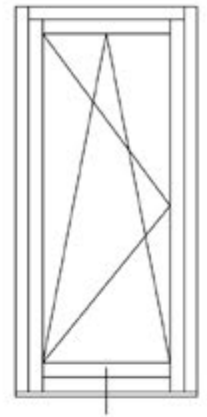

hermod_89

ESCALA 1:1

- (I) Sezione verticale trasverso inferiore con soglia
- (F) Section verticale traverse inferieure avec empilées sur seuil
- (E) Seccion vertical travesañño inferior con umbral
- (UK) Vertical section window-door aluminium lower ledger

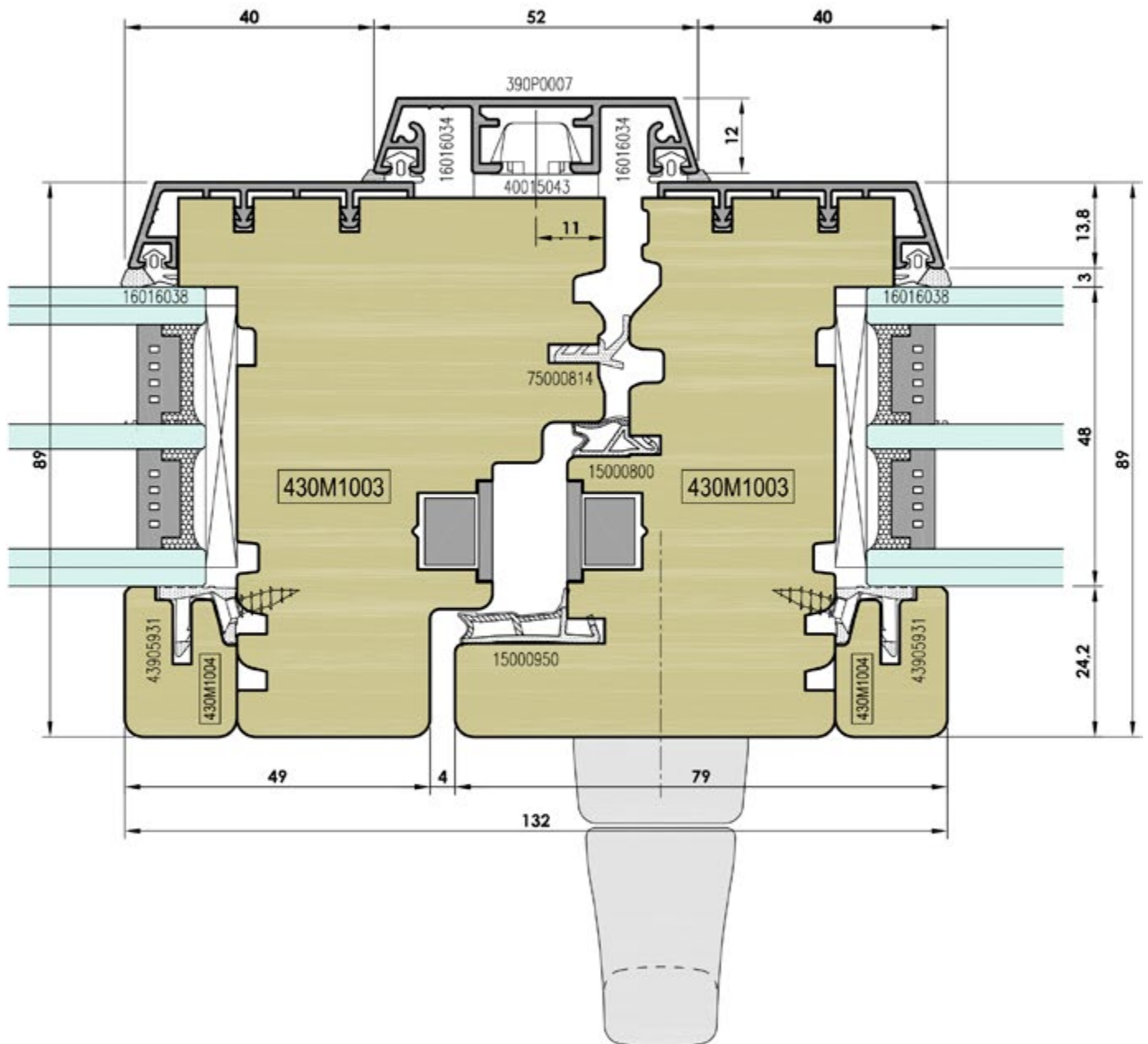
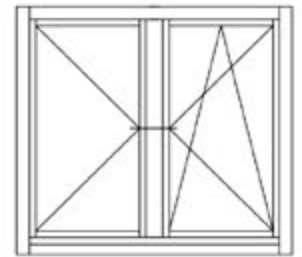

hermod_89

ESCALA 1:1

- (I) Sezione orizzontale snodo centrale
- (F) Section horizontale montant centrale
- (E) Seccion horizontal cierre central
- (UK) Horizontal section of the middle clamp

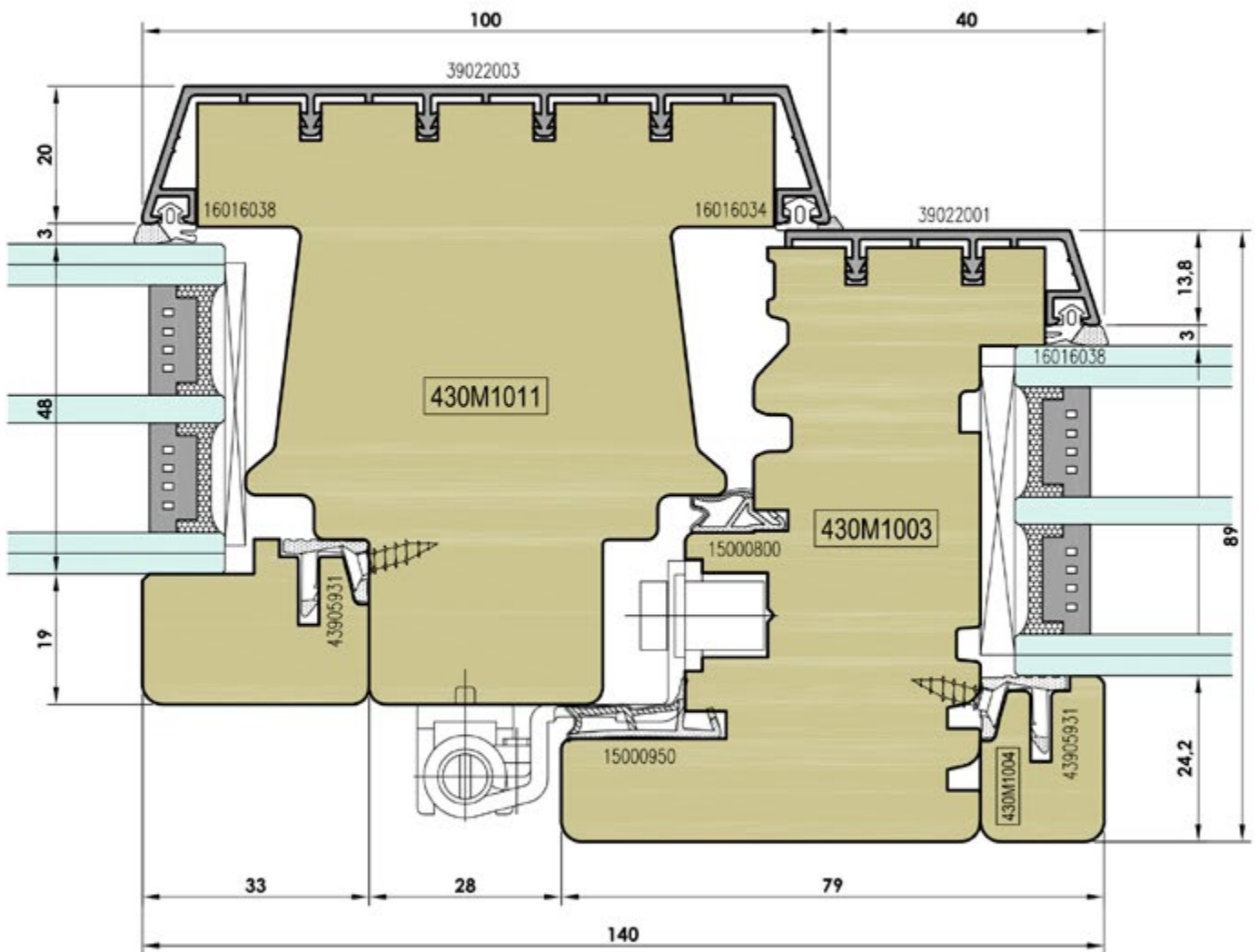
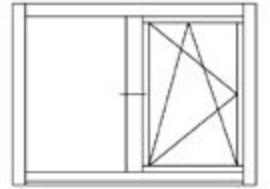

hermod_89

ESCALA 1:1

- (I) Sezione orizzontale montante apribile-fisso
- (F) Section horizontale montant ouvrant-fixe
- (E) Seccion horizontal montante practicable-fijo
- (UK) Horizontal section of the frame's middle ledger

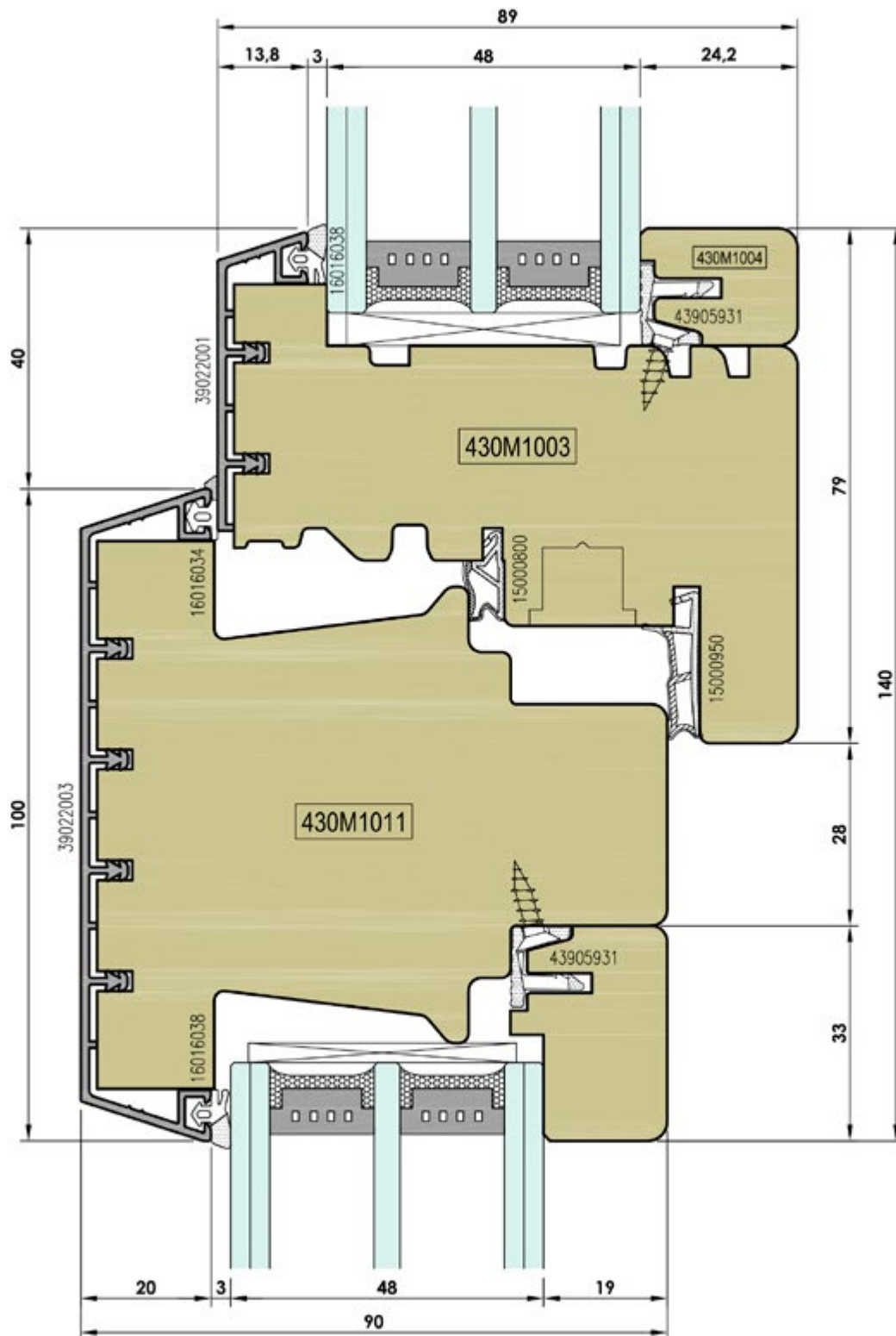
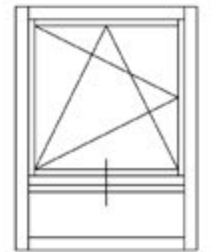

hermod_89

ESCALA 1:1

- (I) Sezione verticale traverso apribile-fisso
- (F) Section verticale traverse ouvrant-fixe
- (E) Seccion vertical travesaño practicable-fijo
- (UK) Vertical section of the frame's middle ledger

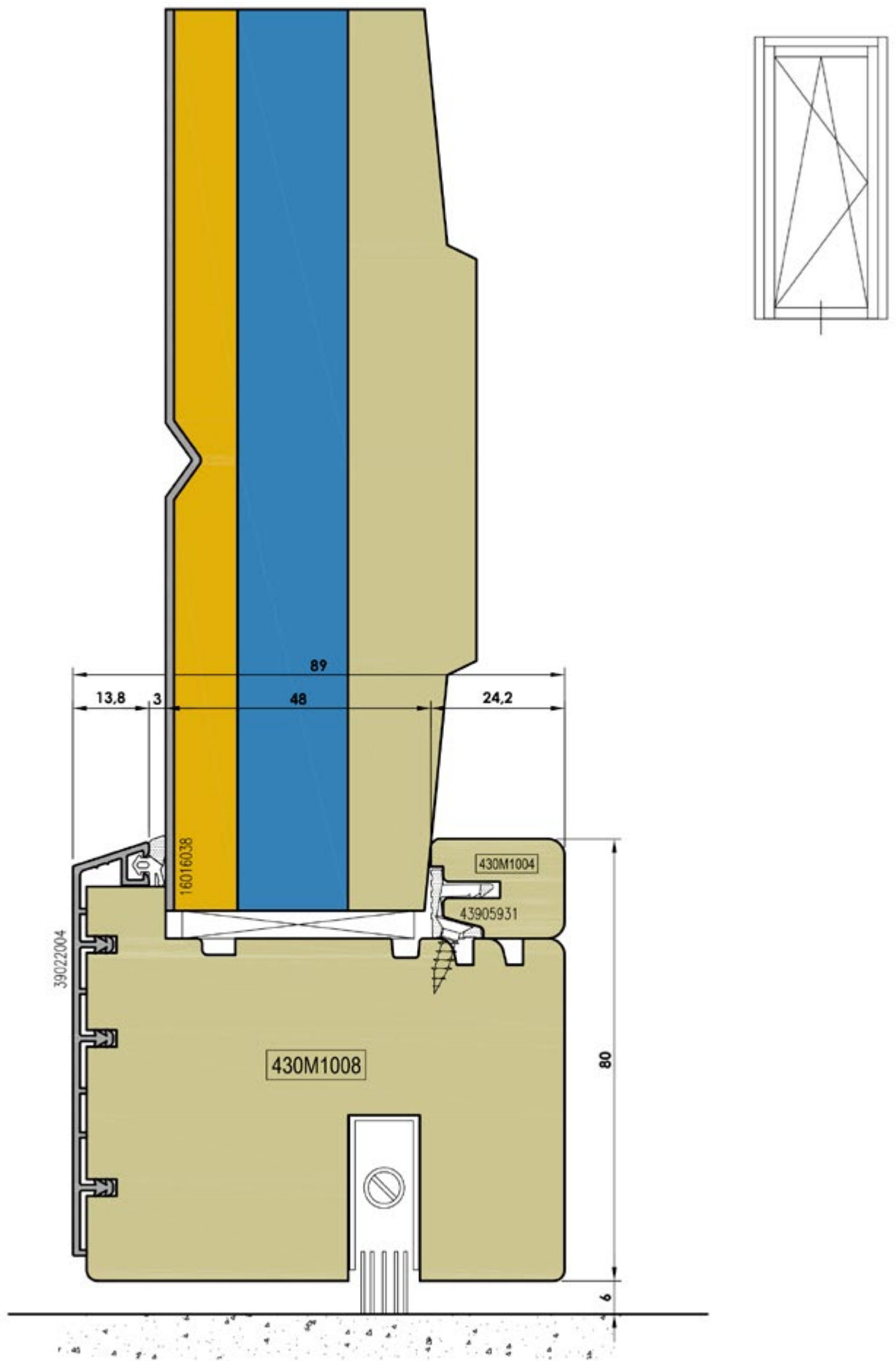

hermod_89

ESCALA 1:1,5

- Ⓛ Sezione verticale traverso inferiore con parafreddo
- ⓕ Section verticale traverse inferieure avec plaintes automatiques
- ⓔ Seccion vertical travesañño inferior con cortavientos
- Ⓢ Vertical section window-door with cold-defender

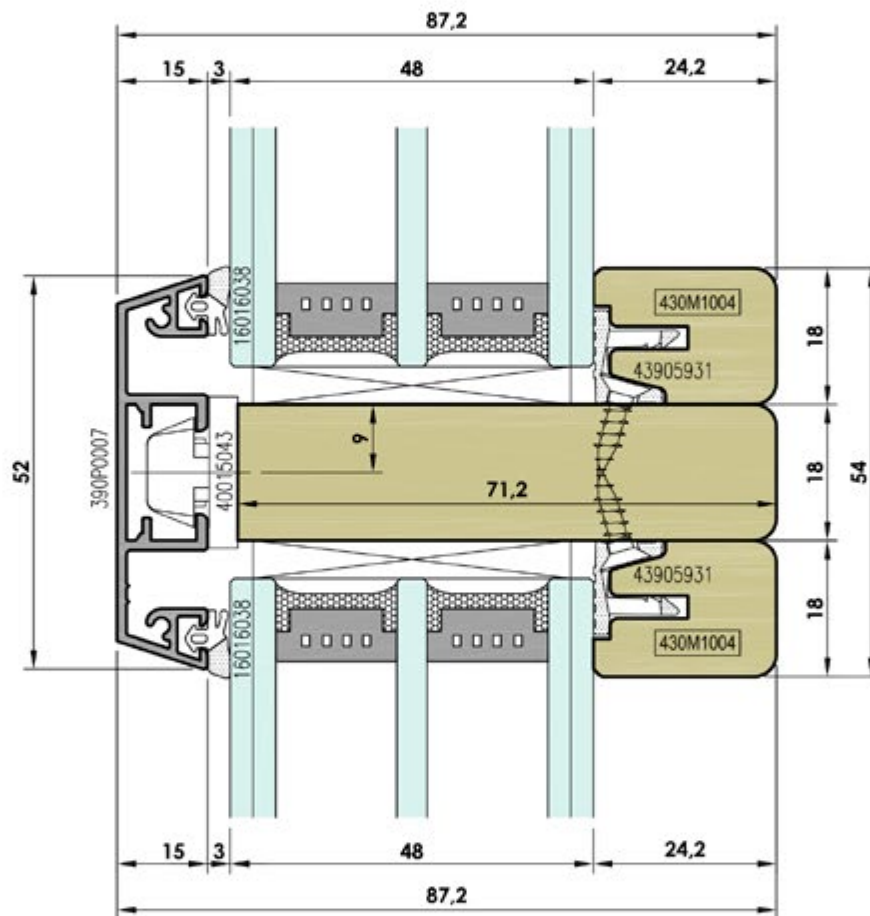
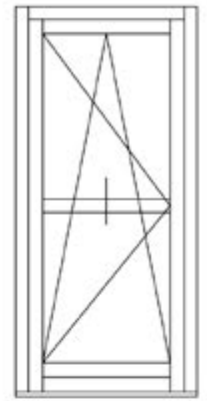

hermod_89

ESCALA 1:1

- (I) Sezione verticale traverso intermedio anta
- (F) Section verticale traverse intermediaire du vatail
- (E) Seccion vertical travesañõ intermedio hoja
- (UK) Vertical section of the wing middle jamb

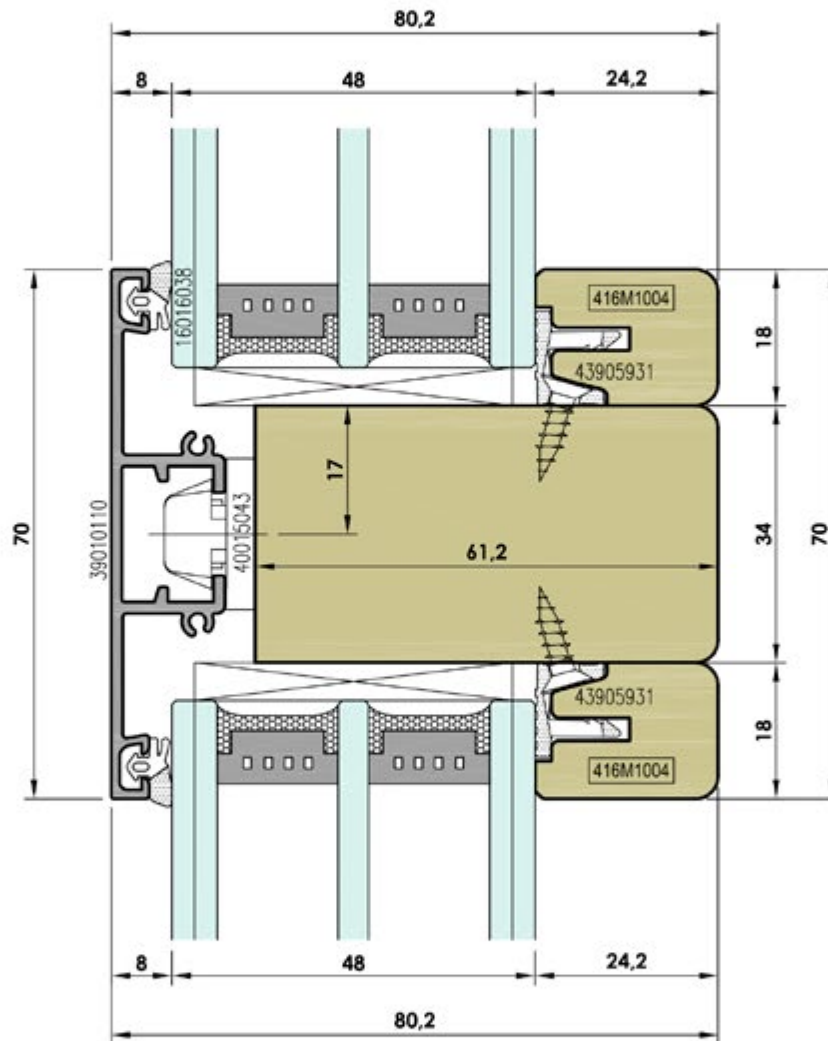
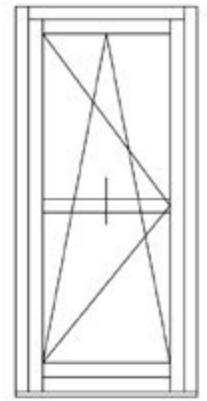

hermod_89

ESCALA 1:1

- (I) Sezione verticale traverso intermedio anta
- (F) Section verticale traverse intermediaire du vaitail
- (E) Seccion vertical travesañño intermedio hoja
- (UK) Vertical section of the wing middle jamb