

hermod_69

ESCALA 1:1

- Ⓛ Sezione verticale traverso inferiore
- Ⓧ Section verticale traverse inferieure
- Ⓧ Seccion vertical travesañño inferior
- Ⓧ Vertical section lower ledger

1

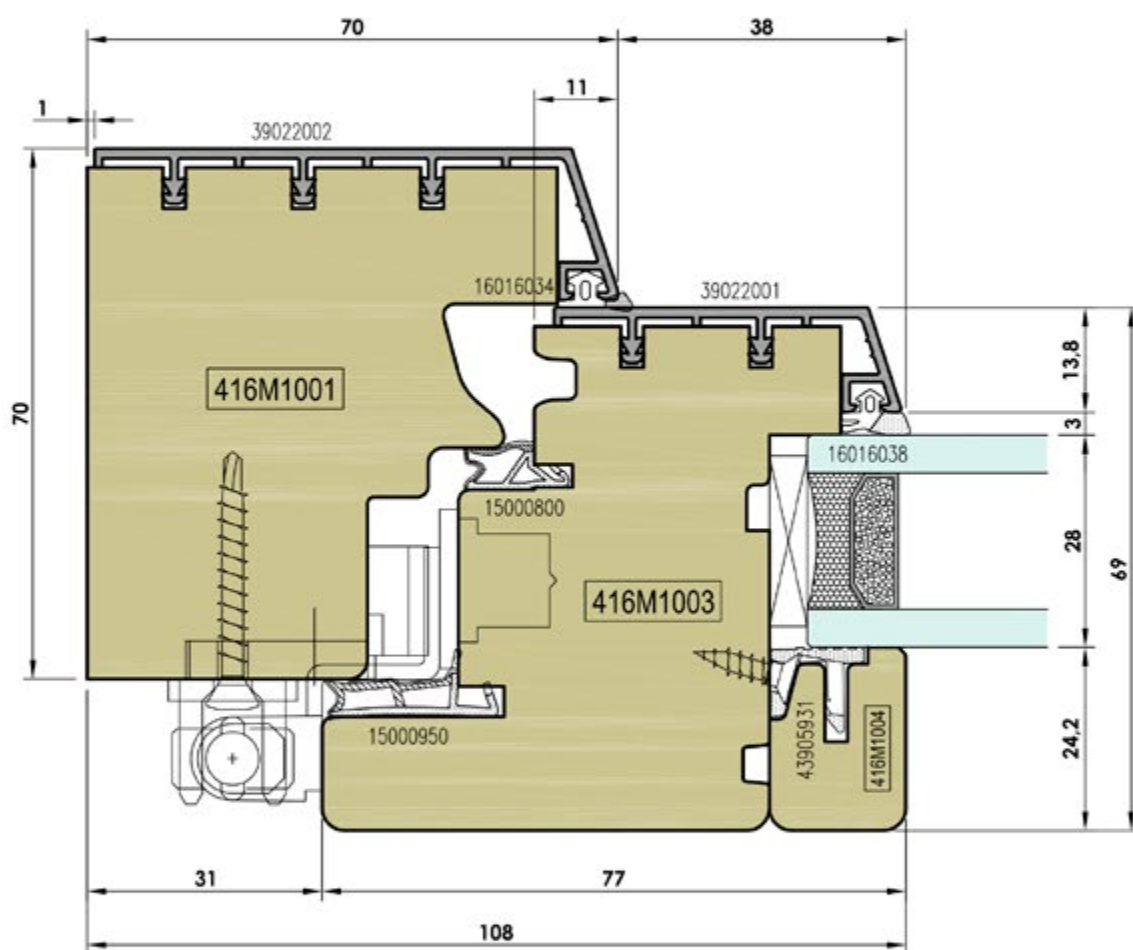
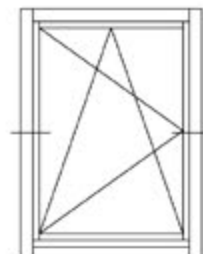

hermod_69

ESCALA 1:1

- Ⓛ Sezione orizzontale montante
- Ⓧ Section horizontale montant
- Ⓧ Seccion horizontal montante
- Ⓧ Horizontal section of the jamb

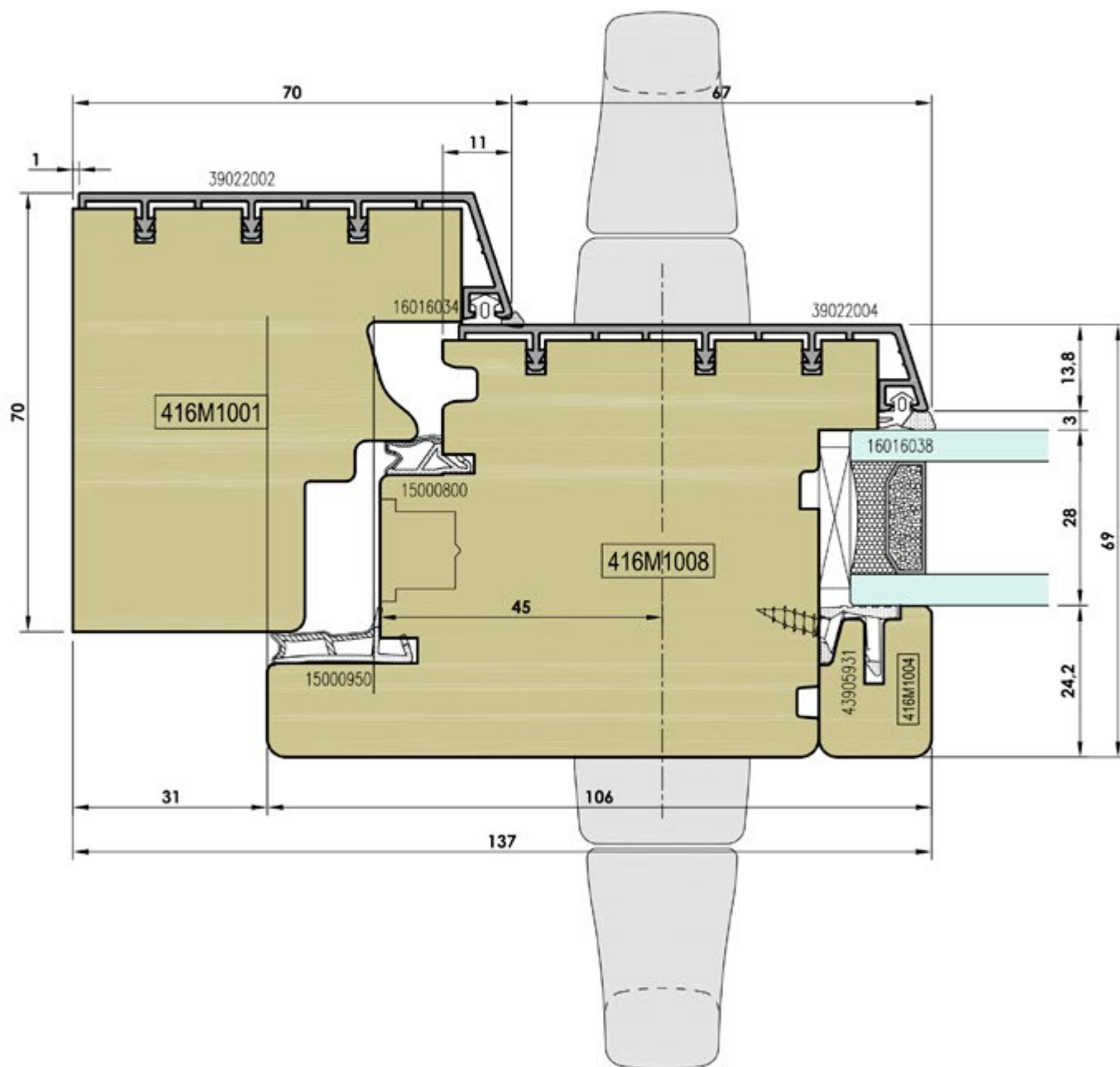
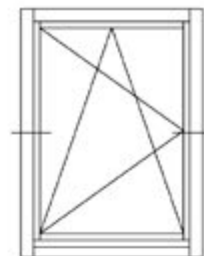

hermod_69

ESCALA 1:1

- Ⓛ Sezione orizzontale montante
- Ⓧ Section horizontale montant
- Ⓧ Seccion horizontal montante
- Ⓧ Horizontal section of the jamb

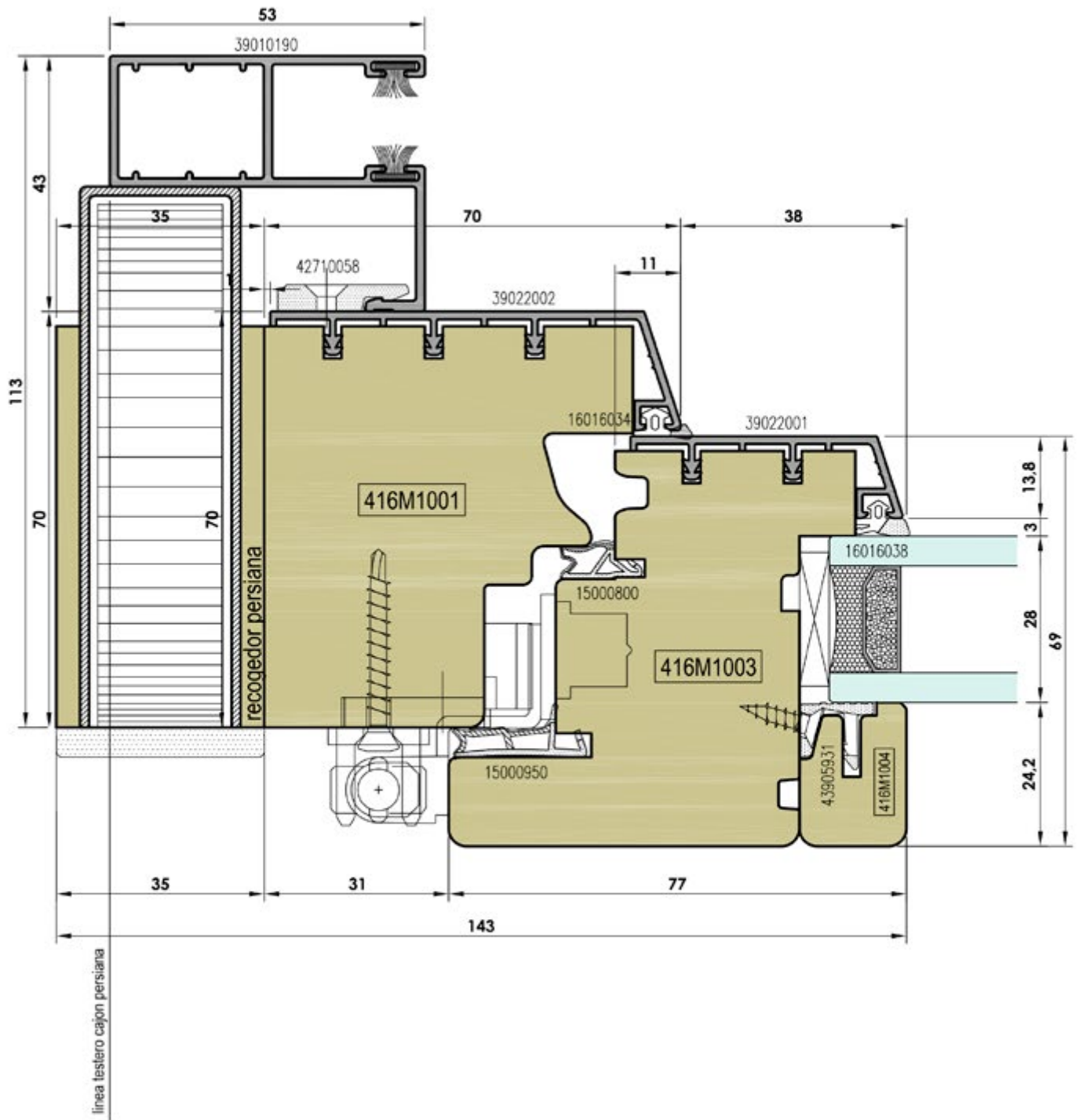
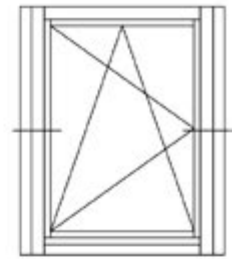

hermod_69

ESCALA 1:1

5

- (I) Sezione orizzontale montante
- (F) Section horizontale montant
- (E) Seccion horizontal montante
- (UK) Horizontal section of the jamb

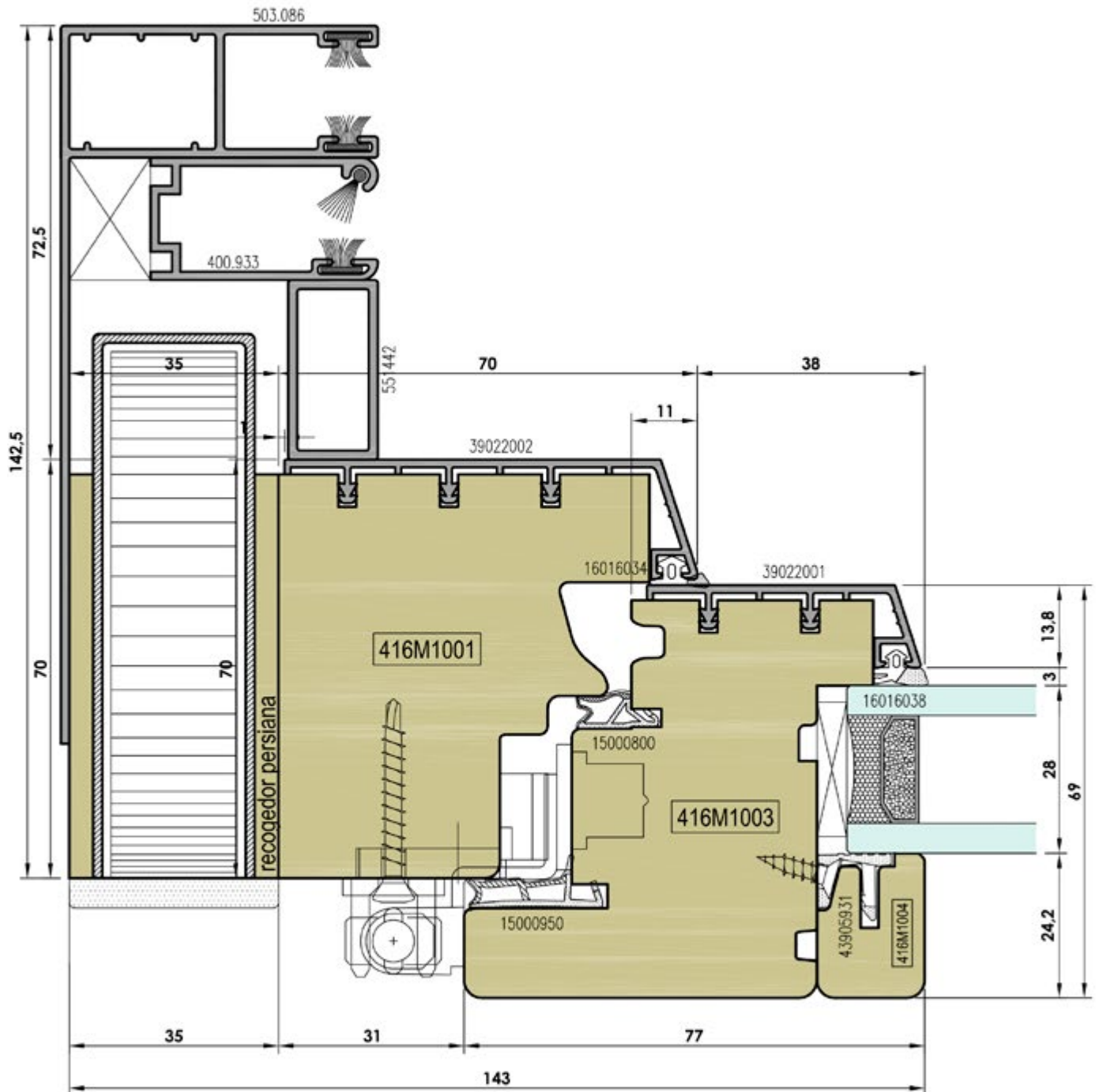
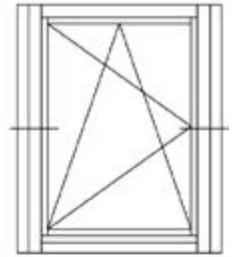

hermod_69

ESCALA 1:1

6

- (I) Sezione orizzontale montante
- (F) Section horizontale montant
- (E) Seccion horizontal montante
- (UK) Horizontal section of the jamb

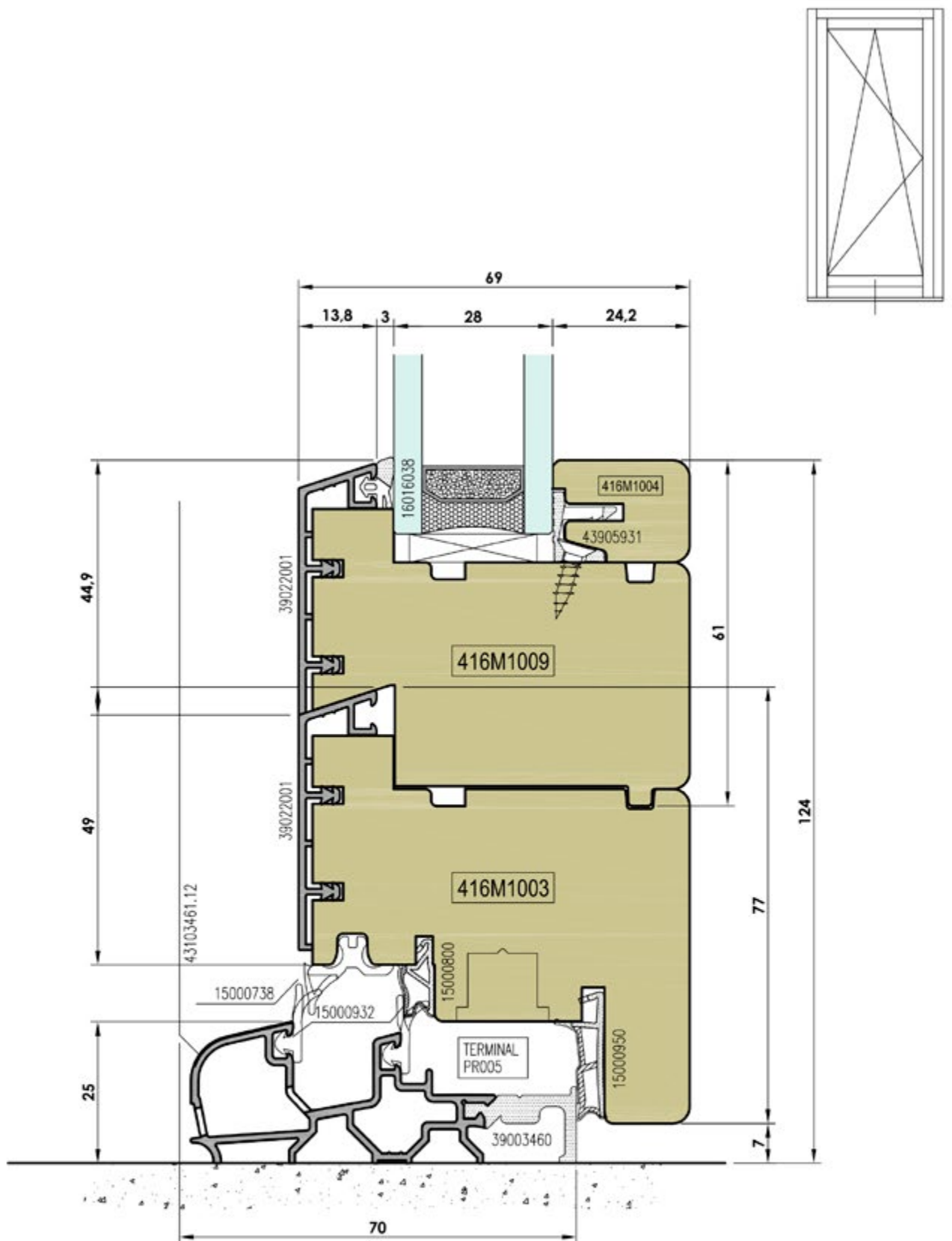

hermod_69

ESCALA 1:1

- Ⓛ Sezione verticale traverso inferiore con soglia
- ⓕ Section verticale traverse inferieure avec empilées sur seuil
- ⓔ Sección vertical travesañño inferior con umbral
- ⓊK Vertical section window-door aluminium lower ledger

7

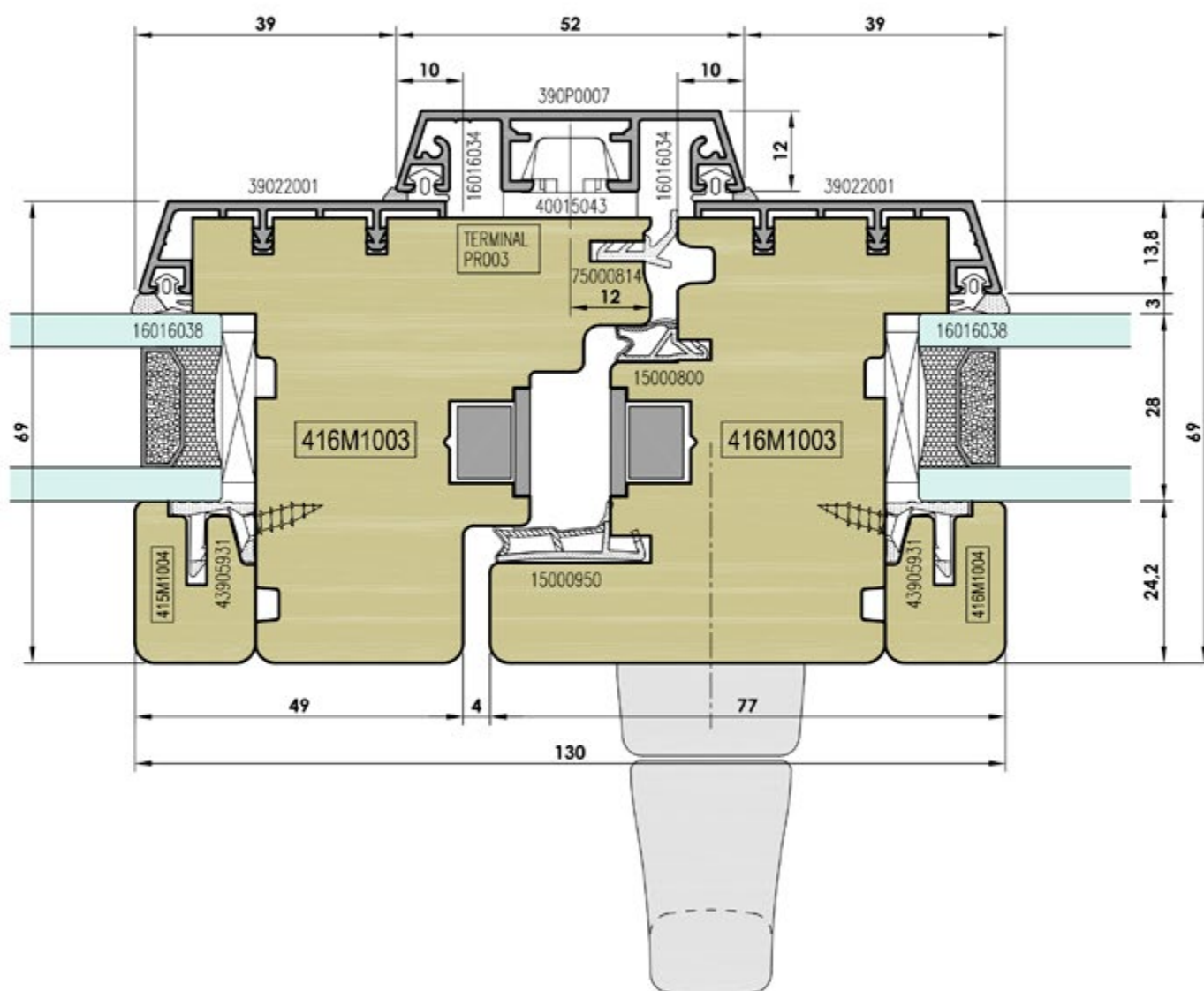
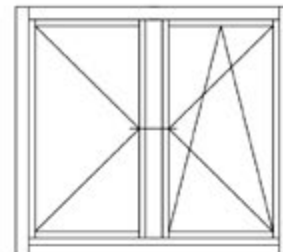

hermod_69

ESCALA 1:1

- (I) Sezione orizzontale snodo centrale
- (F) Section horizontale montant centrale
- (E) Seccion horizontal cierre central
- (UK) Horizontal section of the middle clamp

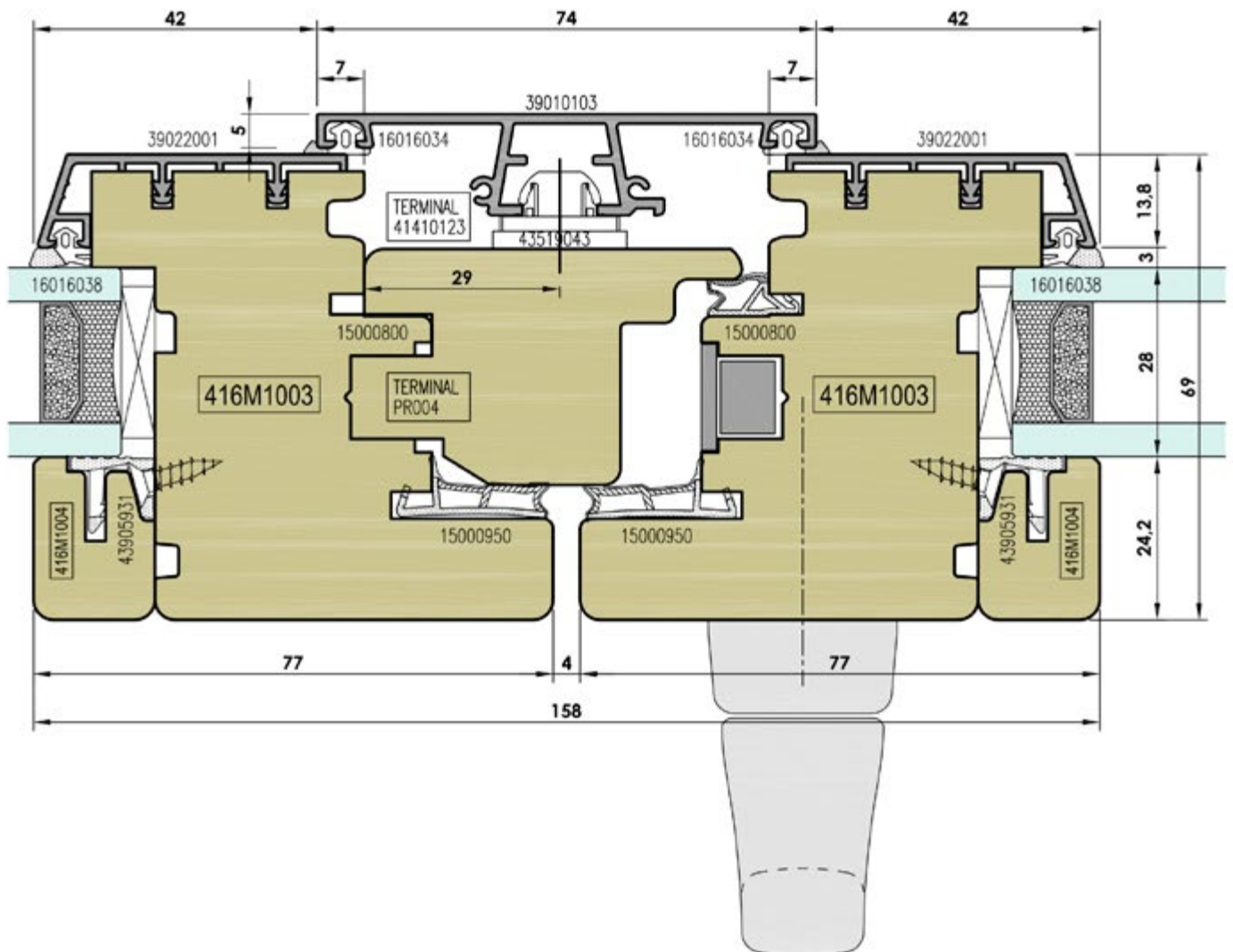
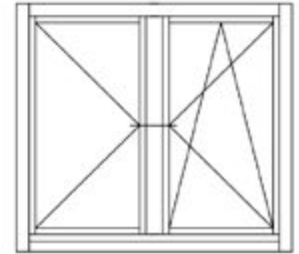

hermod_69

ESCALA 1:1

- Ⓛ Sezione orizzontale snodo centrale
- ⓕ Section horizontale montant centrale
- ⓔ Seccion horizontal cierre central
- ⓊⓀ Horizontal section of the middle clamp

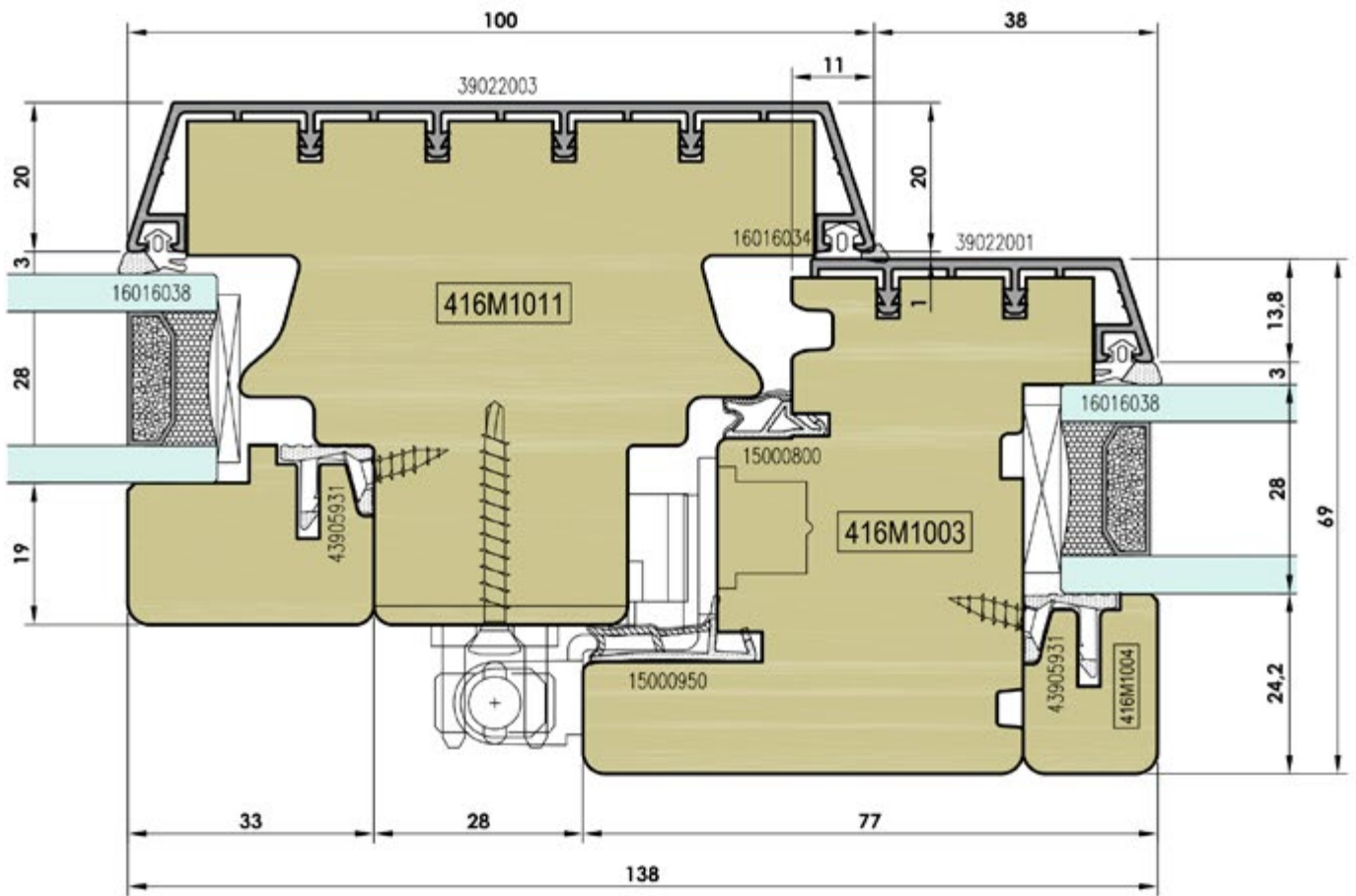
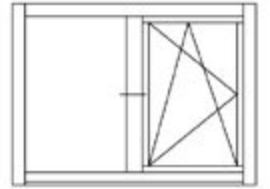

hermod_69

ESCALA 1:1

- Ⓛ Sezione orizzontale montante apribile-fisso
- ⓕ Section horizontale montant ouvrant-fixe
- ⓔ Sección horizontal montante practicable-fijo
- ⓊK Horizontal section of the frame's middle ledger

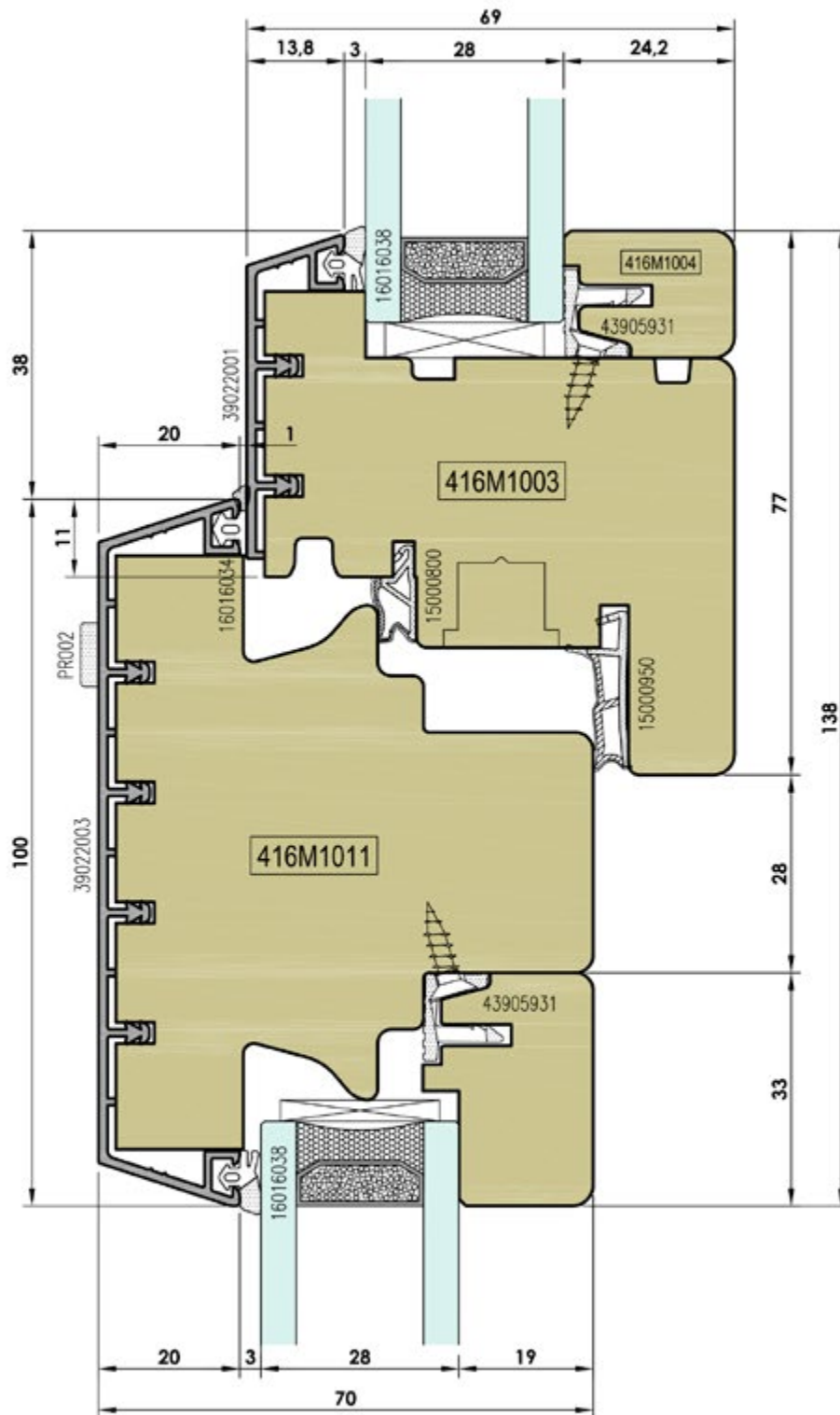
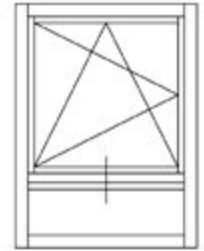

hermod_69

ESCALA 1:1

- ① Sezione verticale traverso apribile-fisso
- ② Section verticale traverse ouvrant-fixe
- ③ Sección vertical travesano practicable-fijo
- ④ Vertical section of the frame's middle ledger

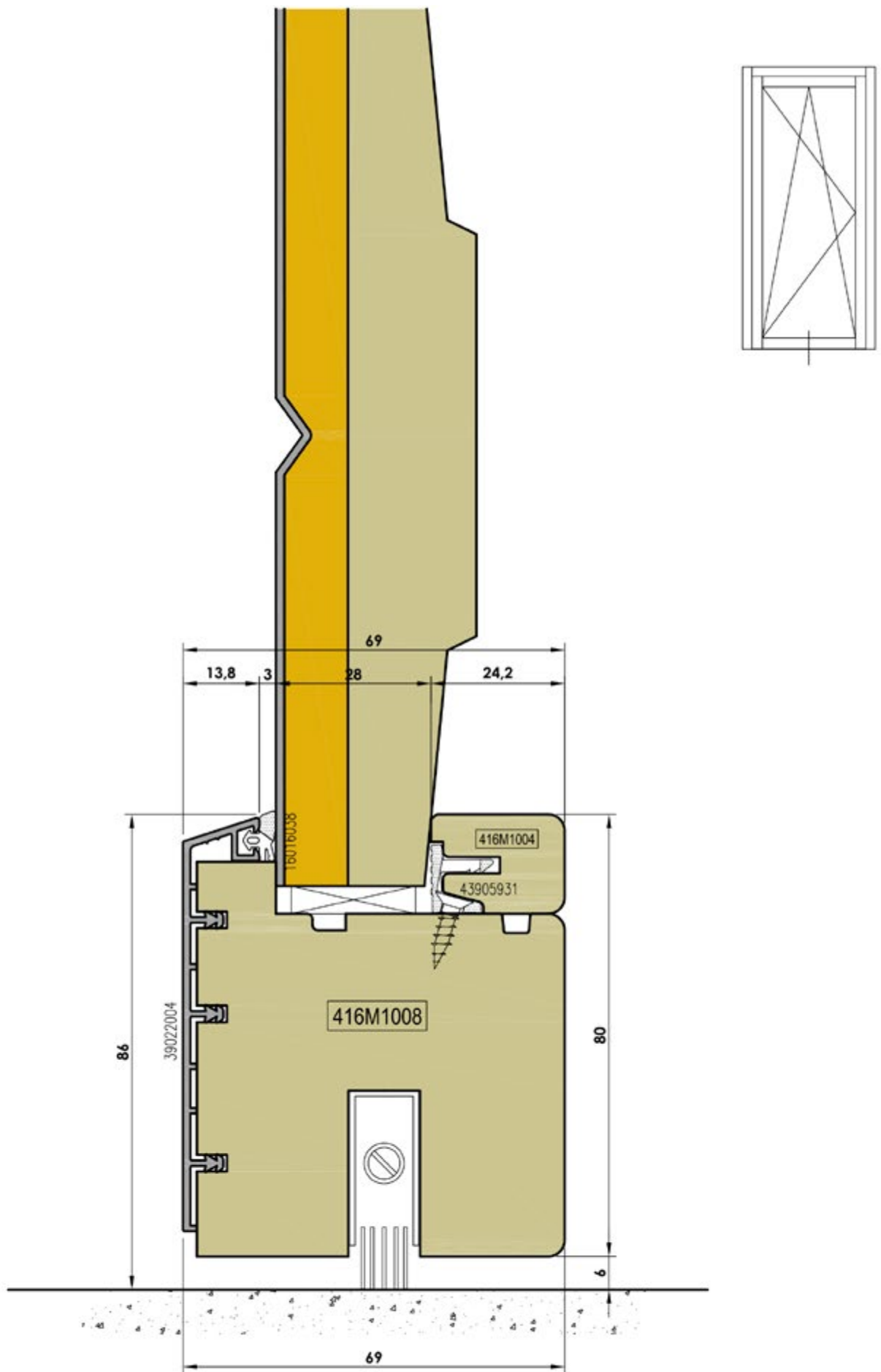

hermod_69

ESCALA 1:1,5

- Ⓡ Sezione verticale traverso inferiore con parafreddo
- Ⓡ Section verticale traverse inferieure avec plaintes automatiques
- Ⓡ Seccion vertical travesaño inferior con cortavientos
- Ⓡ Vertical section window-door with cold-defender

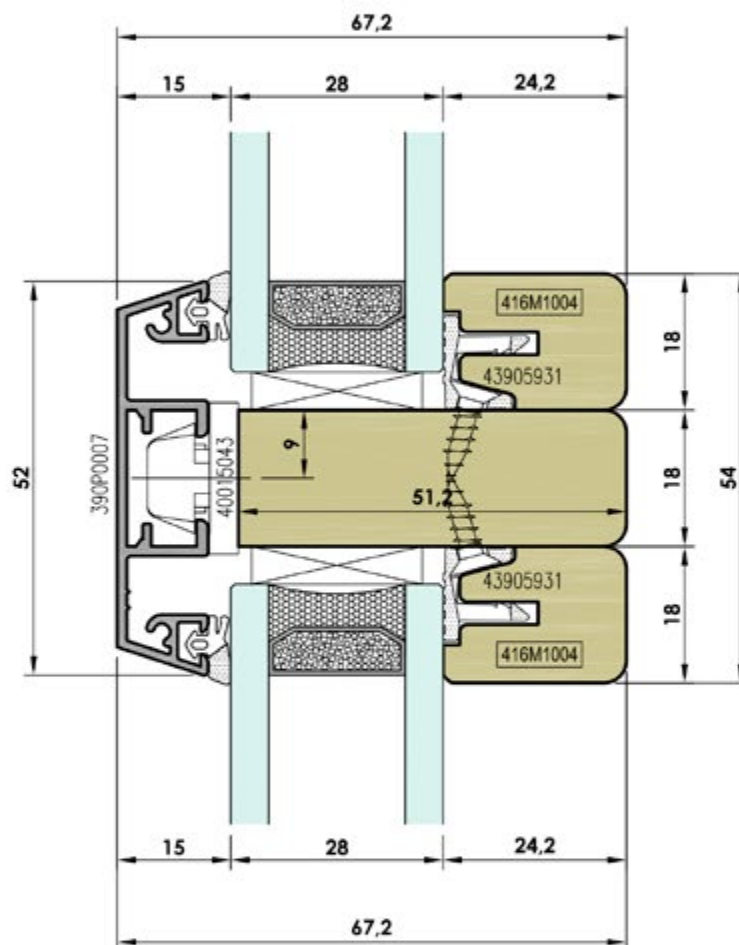
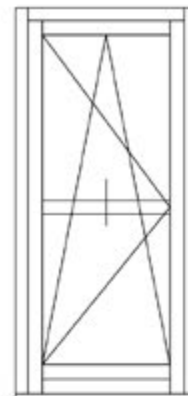

hermod_69

ESCALA 1:1

- Ⓛ Sezione verticale traverso intermedio anta
- Ⓧ Section verticale traverse intermediaire du vatail
- Ⓧ Seccion vertical travesañõ intermedio hoja
- Ⓧ Vertical section of the wing middle jamb

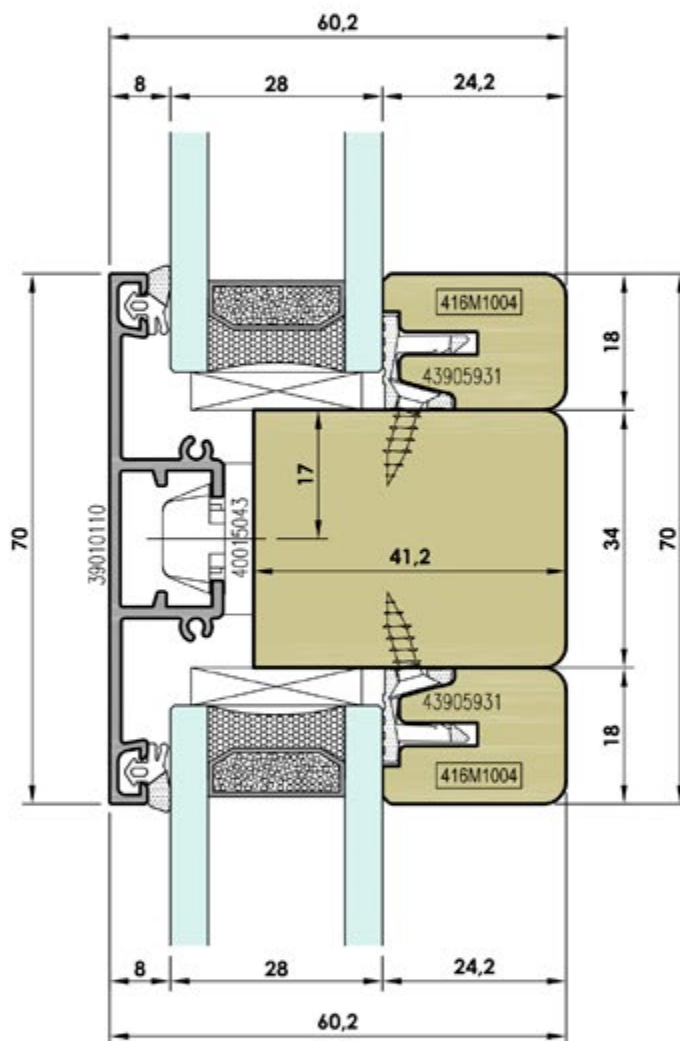
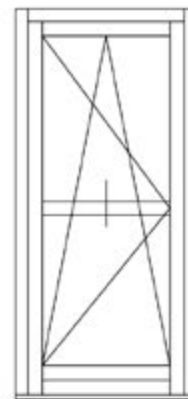

hermod_69

ESCALA 1:1

- Ⓛ Sezione verticale traverso intermedio anta
- Ⓧ Section verticale traverse intermediaire du vatail
- Ⓨ Seccion vertical travesaño intermedio hoja
- Ⓩ Vertical section of the wing middle jamb